

* Outline Dimension(mm)

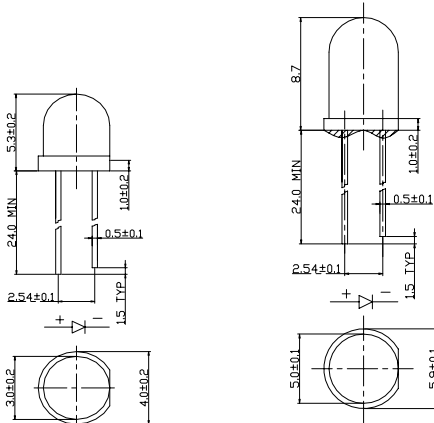

NOTES: 1. ALL DIMENSIONS ARE IN mm , TOLERANCE IS +/-0.25, UNLESS OTHERWISE NOTED.
 2. AN EPOXY MENISCUS MAY EXTEND ABOUT 1.5mm DOWN THE LEADS.
 3. BURR AROUND BOTTOM OF EPOXY MAY BE 0.5mm MAX.

NOTES: 1. ALL DIMENSIONS ARE IN mm , TOLERANCE IS +/-0.25, UNLESS OTHERWISE NOTED.
 2. AN EPOXY MENISCUS MAY EXTEND ABOUT 1.5mm DOWN THE LEADS.
 3. BURR AROUND BOTTOM OF EPOXY MAY BE 0.5mm MAX.

* Far Field Pattern

50% Power Angle : 60° / 45° / 40° / 30° / 25° / 20° / 15°

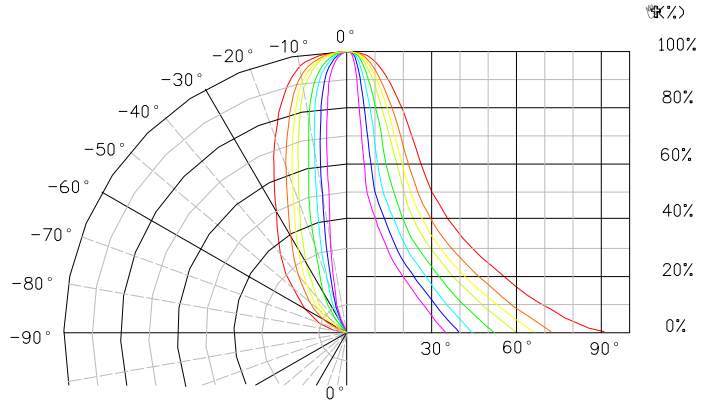

FAR FIELD PATTERN

* Optical-Electrical Characteristics

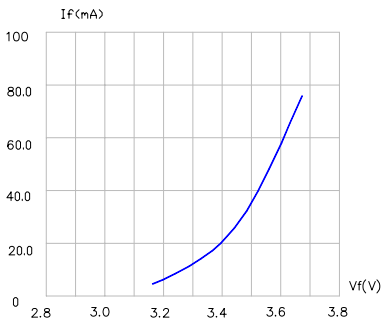

FIG.1 FORWARD CURRENT VS. FORWARD VOLTAGE

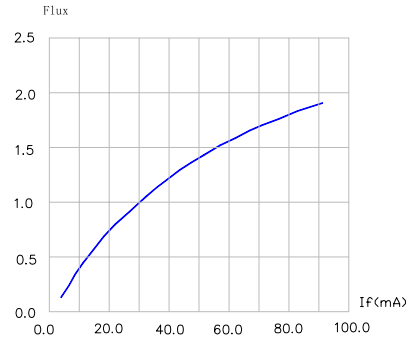

FIG.3 RELATIVE LUMINOUS INTENSITY VS. FORWARD CURRENT.

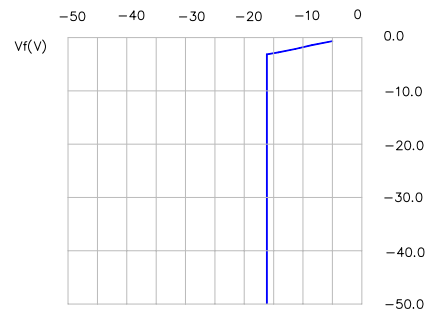

FIG.2 REVERSE CURRENT VS. REVERSE VOLTAGE.

Half Power $\Delta\lambda=150\text{nm}$
 I (RELATIVE LUMINOUS INTENSITY)

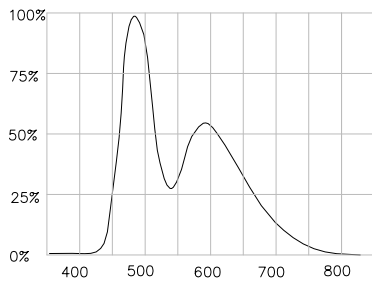

FIG.7 RELATIVE LUMINOUS INTENSITY VS. WAVELENGTH. For WHITE PIRANHA.

I (RELATIVE LUMINOUS INTENSITY)

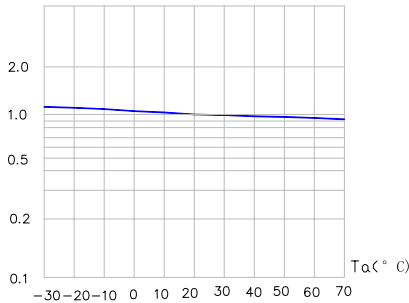

FIG.5 LUMINOUS INTENSITY VS. AMBIENT TEMPERATURE.

I_f (mA)

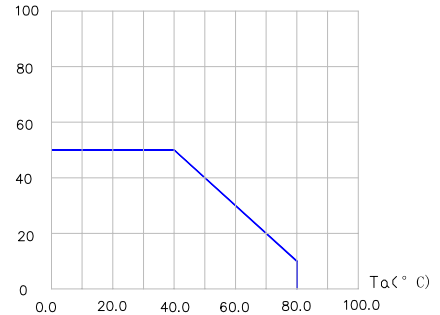

FIG.5 MAXIMUM FORWARD DC CURRENT VS. AMBIENT TEMPERATURE ($T_{jmax}=95^\circ\text{C}$).

.Features

- . High light output.
- . Reliable and rugged
- . I.C. compatible.
- . Low power emission

. Application

- . Advertising Signs
- . Indicators
- . LCD Back Light
- . Illuminations

Part NO.	Viewing Angle (deg)	Size	Lens Color	Chromatic Coordinate		Chip		IV(mcd) (IF=20mA)		Vf(V) (IF=20mA)	
				Min	Max	Material	Emitting Color	Min	Typ	Typ	Max
WCN-301WW1-30N	30	3mm	Water Clear	0.27,0.27	0.32,0.33	AlInGaN	White	1200	1800	3.3	3.8
WCN-501WW1-15N	15	5mm	Water Clear	0.27,0.27	0.32,0.33	AlInGaN	White	6000	8000	3.3	3.8
WCN-502WW1-15N	15	5mm	Water Clear	0.27,0.27	0.32,0.33	AlInGaN	White	9000	10000	3.3	3.8
WCN-503WW1-15N	15	5mm	Water Clear	0.27,0.27	0.32,0.33	AlInGaN	White	13000	15000	3.3	3.8
WCN-501WW1-20N	20	5mm	Water Clear	0.27,0.27	0.32,0.33	AlInGaN	White	9000	10000	3.3	3.8
WCN-501WW1-25N	25	5mm	Water Clear	0.27,0.27	0.32,0.33	AlInGaN	White	2700	4000	3.3	3.8
WCN-503WW1-30N	30	5mm	Water Clear	0.27,0.27	0.32,0.33	AlInGaN	White	1800	3000	3.3	3.8
WCN-501WW1-40N	40	5mm	Water Clear	0.27,0.27	0.32,0.33	AlInGaN	White	1500	2500	3.3	3.8
WCN-501WW1-45N	45	5mm	Water Clear	0.27,0.27	0.32,0.33	AlInGaN	White	1200	2000	3.3	3.8
WCN-501WW1-50N	50	5mm	Water Clear	0.27,0.27	0.32,0.33	AlInGaN	White	1500	2500	3.3	3.8
WCN-501WW1-60N	60	5mm	Water Clear	0.27,0.27	0.32,0.33	AlInGaN	White	800	1200	3.3	3.8
WCN-801WW1-25N	25	8mm	Water Clear	0.25,0.26	0.35,0.36	AlInGaN	White	1600	2300	3.3	3.8
WCN-801WW1-20N	20	8mm	Water Clear	0.25,0.26	0.35,0.36	AlInGaN	White	1800	2500	3.3	3.8
WCN-801WW1-50N	50	8mm	Water Clear	0.25,0.26	0.35,0.36	AlInGaN	White	500	1000	3.3	3.8
WCN-A01WW1-25N	25	10mm	Water Clear	0.25,0.26	0.35,0.36	AlInGaN	White	1600	2500	3.3	3.8

Any request type is not listed above, contact with us for more please!